

ABLE

10 K SHORING

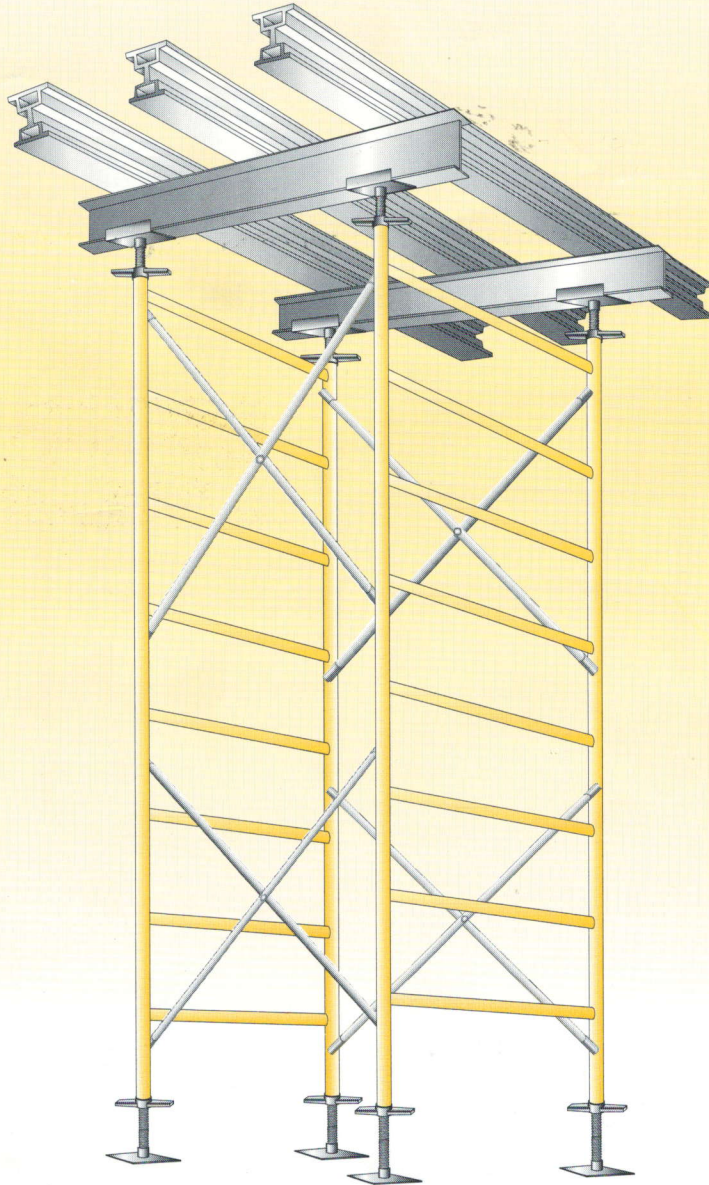

ABLE

INDUSTRIES, INC.
ABLE BUILDERS EQUIPMENT
Central Mail Facility
P.O. BOX 667567 MIAMI, FL 33166-7567
MIAMI: (305) 592-5940
FAX: (305) 593-5468
FLA WATS: 1-800-894-6290

WEB SITE: <http://www.AbleBuilders.com>
E-MAIL: sales@AbleBuilders.com
Links: www.AbleExport.com
www.AbleGreen-Go.com
www.Andamio.com
www.Escora.com

10K Frames

ABLE

SINCE 1954

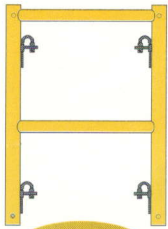

SH-23

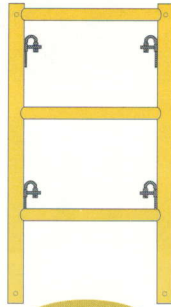

SH-24

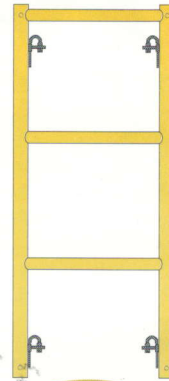

SH-25

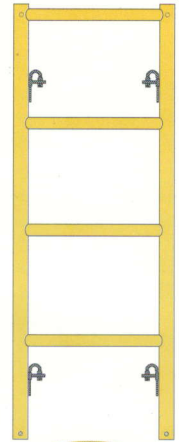

SH-26

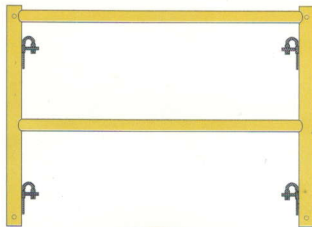

SH-43

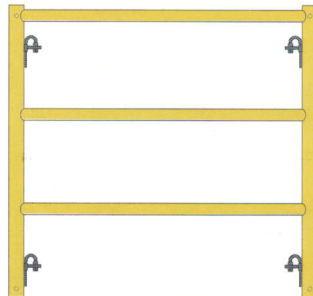

SH-44

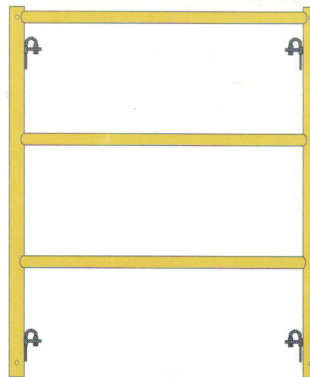

SH-45

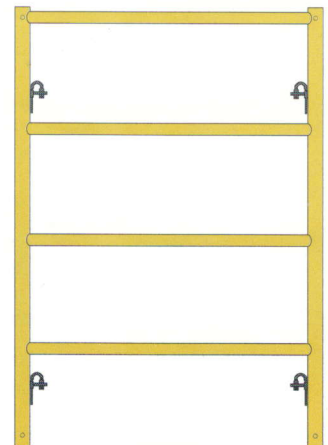

SH-46

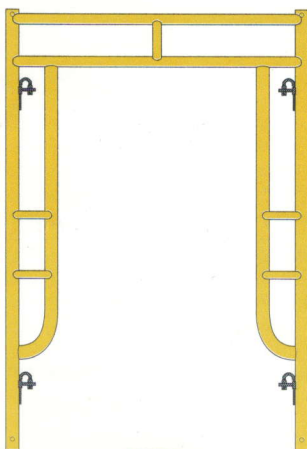

SH-46W

Specifications

Item	Description	Weight (lbs)	Weight (kgs)
SH-23	2' X 3'	25.0	11.34
SH-24	2' X 4'	37.0	16.78
SH-25	2' X 5'	45.0	20.41
SH-26	2' X 6'	58.0	26.31
SH-43	4' X 3'	34.0	15.42
SH-44	4' X 4'	46.0	20.87
SH-45	4' X 5'	54.0	24.49
SH-46	4' X 6'	67.0	30.39
SH-46W	4' X 6' Walk Thru	69.0	31.30

Components

Cross Braces

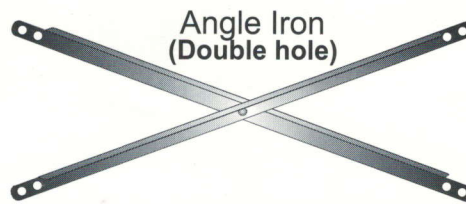
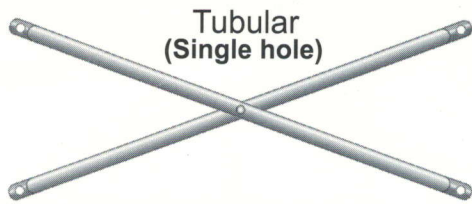

To order Angle Iron, add suffix "A" to Item Number (e.g., Item B-42 is Tubular and B-42A is Angle Iron).

Item	Description	Item	Description	Item	Description
B-42	4' X 2'	B-72	7' X 2'	B-434	4' X 3' X 4'
B-43	4' X 3'	B-73	7' X 3'	B-534	5' X 3' X 4'
B-44	4' X 4'	B-74	7' X 4'	B-634	6' X 3' X 4'
B-52	5' X 2'	B-82	8' X 2'	B-734	7' X 3' X 4'
B-53	5' X 3'	B-83	8' X 3'	B-834	8' X 3' X 4'
B-54	5' X 4'	B-84	8' X 4'	B-1034	10' X 3' X 4'
B-62	6' X 2'	B-102	10' X 2'		
B-63	6' X 3'	B-103	10' X 3'		
B-64	6' X 4'	B-104	10' X 4'		

Interchangeable Frame Heads



SH-HP

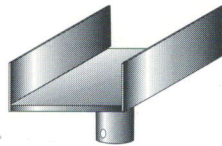

SH-UH

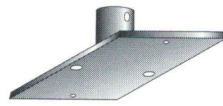

SH-BP

Item	Description
SH-HP	8" X 8" Plate Head
SH-UH	8" X 8" U Head
SH-BP	7" X 9" Base Plate

Interchangeable Screw Heads



SH-HPS

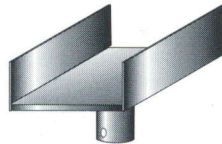

SH-UHS

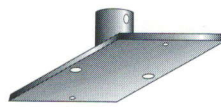

SH-BPS

Item	Description
SH-HPS	8" X 8" Plate Head
SH-UHS	8" X 8" U Head
SH-BPS	7" X 9" Base Plate

Accessories



SH-BC

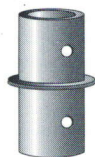

SH-CP



SH-NP



SH-RH



SH-SJ

Item	Description
SH-BC	Beam Clamp
SH-CP	Coupling Pin
SH-NP	Nailing Plate for Frame Leg
SH-RH	Rivet and Hitch Pin 3"
SH-SJ	Adjusting Screw 36"

GIVE TO ERECTOR / USER OR POST ON JOB SITE

Code of Safe Practices for 10 K Shoring

Developed for Industry by:
Scaffold Industry Association, Inc.
<http://www.scaffold.org>

It shall be the responsibility of all users to read and comply with the following common sense guidelines which are designed to promote safety in the erecting, dismantling and use of Shoring. These guidelines do not purport to be all inclusive nor to supplant or replace other additional safety and precautionary measures to cover usual or unusual conditions. If these guidelines in any way conflict with any state, local, federal or other government statute or regulations, said statute or regulation shall supersede these guidelines and it shall be the responsibility of each user to comply therewith.

1. General Guidelines

- a) Post these **Shoring Safety Guidelines** in a conspicuous place and be sure that all persons who erect, dismantle or use post shores are aware of them.
- b) Follow all state, local and federal codes, ordinances and regulations pertaining to shoring.
- c) Survey the job site. A survey shall be made of the job site for hazards, such as untamped earth fills, ditches, debris, high tension wires, unguarded openings, and other hazardous conditions created by other trades. These conditions should be corrected or avoided as noted in the following sections.
- d) Inspect all equipment before using. Never use any equipment that is damaged or defective in any way. Remove it from the job site.
- e) Shoring must be erected in accordance with design and or manufacture's recommendations.
- f) Do not erect, dismantle or alter any shoring unless under the supervision of a qualified person.
- g) Erected shoring should be continually inspected by users to be sure that they are maintained in a safe condition. Report any unsafe condition to your supervisor.
- h) Never take chances! If in doubt regarding the safety or use of shoring, consult your shoring supplier.
- i) Never use equipment for purposes or in ways for which it was not intended.

2. Design

- a) Shoring installations constructed in accordance with these recommended safety requirements shall require a shoring layout.
- b) The shoring layout shall include details accounting for unusual conditions such as heavy beams, sloping areas, ramps, and cantilevered slabs, as well as plan and elevation views, and applicable construction notes.
- c) A copy of the shoring layout shall be available and used on the job site at all times.
- d) The shoring layout shall be prepared or approved by a person qualified to analyze the loadings and stresses, which are induced during the construction process.
- e) A minimum total design load for any formwork and shoring used in a slab and beam structure shall be not less than 100 lbs. per square foot for the combined live and dead load regardless of slab thickness; however, the minimum allowance for live load shall be not less than 20 lbs. per square foot.
- f) When motorized carts or buggies are used, the design load, as described in Section 2.a shall be increased 25 lbs. per square foot.
- g) Allowable loads shall be based on a safety factor consistent with the type of shoring used and as set forth in Section 3.
- h) The design stresses for form lumber and timbers shall commensurate with the grade, conditions, and species of lumber used, in accordance

with the current edition of the "National Design Specification for Stress-Grade Lumber and its Fastenings." (National Forest Products Association)

- i) Design stresses may be increased for short term loading conditions as provided in the current edition of "The Wood Structure Design Data Book." (National Forest Products Association)
- j) The design stresses used for form lumber and timber shall be shown on all drawings, specifications and shoring layouts.

3. Shoring

- a) Metal tubular frames used for shoring shall have allowable loads based on testes conducted according to a standard test procedure for the Compression Testing of Scaffolds and Shores, as established by the Scaffolding, Shoring & Forming Institute, Inc.
- b) Design of shoring layouts using tubular welded frames shall be based on allowable loads which were obtained using these test procedures, and at least a 2.5 to 1 safety factor.
- c) All metal frame shoring equipment shall be inspected before erection by the contractor who erects the equipment.
- d) Metal frame shoring equipment and accessories shall not be used if excessively rusted, bent, dented, rewelded beyond the original factory weld locations, having broken welds, or having defects.
- e) All components shall be in good working order and in a condition similar to that of original manufacture.
- f) When checking the erected shoring frames with the shoring layout, the spacing between towers and cross brace spacing shall not exceed that shown on the layout, and all locking devices shall be in the closed position.
- g) Devices to which the external lateral stability bracing are attached shall be securely fastened to the legs of the shoring frames.
- h) Base plates, shore heads, extension devices, or adjustment screws shall be in firm contact with the footing sill, and/or the form material, and shall be snug against the legs of the frame.
- i) There shall be no gaps between the lower end of one frame and the upper end of the other frame.
- j) Any component which cannot be brought into proper alignment or contact with the component into or onto which it is intended to fit, shall be removed and replaced.
- k) When two or more tiers of frames are used, they shall be cross braced. Towers shall have lateral bracing in accordance with manufactures' recommendations and as shown on the shoring layout.
- l) Eccentric loads on shore heads and similar members shall be avoided.
- m) Special precautions shall be taken when formwork is at angles or sloping, or when the surface shored from is sloping.
- n) Adjustment screws shall not be adjusted to raise formwork during concrete placement.
- o) Work platform brackets shall not be used for carrying shoring loads.

These safety guidelines (Code of Safe Practice) set forth common sense procedures for safely erecting, dismantling and using post shores. However, equipment and shoring systems differ, and accordingly, reference must always be made to the instructions and procedures of the supplier and or manufacturer of the equipment. Since field conditions vary and are beyond the control of the Scaffold Industry Association, safe and proper use of shoring is the sole responsibility of the user.

B13 2500 7/00

ABLE

INDUSTRIES, INC.
ABLE BUILDERS EQUIPMENT
Central Mail Facility
P.O. BOX 667567 MIAMI, FL 33166-7567
MIAMI: (305) 592-5940
FAX: (305) 593-5468
FLA WATS: 1-800-894-6290

WEB SITE: <http://www.AbleBuilders.com>
E-MAIL: sales@AbleBuilders.com
Links: www.AbleExport.com
www.AbleGreen-Go.com
www.Andamio.com
www.Escora.com